

## Single Use Wet Curing Blanket for DOT Applications

### Superior Hydration

When concrete strength is everything, UltraCure™ is the wet curing method chosen by top professionals to provide thorough hydration, less discoloration and a more evenly cured slab. Unlike other single-use blankets which tend to dry out after 3-4 days, UltraCure™ DOT (Natural Cellulose Fabric) provides constant hydration and maintains a 100% relative humidity condition on the slab for the entire 14 day curing period.

### Wet Curing

- Increases concrete strength and durability
- Reduces permeability of concrete
- Improves abrasion resistance
- Reduces cracking, crazing, dusting and efflorescence
- Helps prevent plastic shrinkage cracking
- Higher volume stability

### The Technology

• **UltraCure DOT – (Outdoor / 7-14 Day)** features super absorbent fibers that effectively trap water and serve as a hydrating reservoir for the slab as it cures. UltraCure DOT also features a perforated white reflective poly backing which provides constant visual reinforcement that the slab remains wet for the entire curing period. With proper installation, UltraCure DOT provides constant hydration and maintains a 100% relative humidity condition on the slab for the entire 14 day curing period.

*“After proper placement and finishing of suitable quality concrete, curing is the single most important factor in achieving a high quality slab”.*  
— ACI 302 R1-04

### Why UltraCure Works

UltraCure™ blankets feature natural cellulose, super absorbent, non-staining fibers that effectively trap water, provide thorough hydration, less discoloration and a more evenly cured slab. UltraCure DOT also features a white reflective poly backing which provides constant visual reinforcement that the slab remains wet for the entire curing period. The superior water retention ability of UltraCure DOT allows the blanket to absorb up to 55 gallons of curing water per 800 sq. ft. roll, providing the critical moisture required for the long term wet curing of concrete surfaces.

### User Friendly

- Lightweight: each roll weights approx. 50 pounds
- Roll outs flat and stays flatter than many other wet cure methods which reduces trapped air and discoloration.
- Rolls come with fabric side out, making it easy to install
- No Taping the seams

### Cost Effective

Using UltraCure DOT also helps reduce material costs, installation labor, re-wetting time and costs, totally eliminates the need of costly storage and transportation of traditional wet cure methods.



## Single Use Wet Curing Blanket

UltraCure DOT™  
 Disposable Wet Cure Blanket  
 Material Specifications Submittal

### Material Specification:

UltraCure DOT™ moisture-retaining coverings by McTech Group, Inc. are natural colored cellulose fabrics with a perforated reflective vapor barrier applied to one side to help provide minimize concrete overheating, maintain moisture levels and provide protection against UV degradation. Also available in non-perforated for vertical applications. Both non-staining fabrics have a tensile strength meeting ASTM D-882 and a minimum retention capacity of 6.5(g). Material shall meet or exceed ASTM C171-03, ASTM C171-97a and AASHTO M171-00, standard specifications for sheet materials for curing concrete slabs or pavement.

### Application:

Place UltraCure DOT™ wet cure covering in widest practical width as soon as concrete has hardened sufficiently to prevent surface damage. Edges and ends shall be lapped 4"- 6". Install UltraCure DOT™ moisture containing wet cure covering material as per manufacturer's written instructions as soon as practical and while the surface of the concrete is still moist. After installing the blanket on the slab surface, wet top surface of curing blanket with 1/8" to 1/4" inch of water to cover entire surface area of blanket. Monitor surface temperature of concrete and continue to apply curing water to the top of the curing blanket until concrete surface is within 15 degrees of ambient temperature. No portion of this product shall be re-used once it has been put into use on a slab on grade or other concrete application.

Maintain UltraCure DOT™ in place on concrete for a period of not less than seven (7) days and up to (14) days after placement. Continuous inspection for the purpose of maintaining 100 % curing blanket contact with surface to be cured is recommended using appropriate restraints placed to keep the material in place for outside use where wind could be an issue. Periodic monitoring of moisture retention in the curing blanket is recommended and additional water should be applied if required.

\*Please refer to detailed installation instructions of varied methods for local or State applications.

### Physical Properties – UltraCure DOT™

Property	Value	Test Method
Caliper	1.7 mm	ASTM D – 5199
Tensile	TD – 3733 psi MD – 2872 psi	ASTM D - 882
Elongation	TD – 90% MD – 110%	ASTM D - 882
Absorption	800%	WSP 10.1
Dart	300g	ASTM D -1709
Reflectance	>70%	ASTM E - 1447

#### Technical Assistance Contact:

McTech Group, Inc.  
 3502 Diversified Drive  
 Loganville, Ga. 30052  
 Toll Free: 1-866-913-8363  
 Fax: 770-913-8307  
 Web: [www.McTechGroup.com](http://www.McTechGroup.com)

The information provided herein is based upon data believed to be reliable. All testing is performed with ASTM standards and procedures. All values are typical and nominal and do not represent either minimum or maximum performance of the product. Although the information is accurate to the best of our knowledge and belief, no representation of warranty or guarantee, express or implied, or merchantability, fitness or otherwise, is made as to product application for a particular use. ©2009, McTech Group, Inc. All rights reserved.

## Single Use Wet Curing Blanket

The Ultimate Wet Cure Fabric for Vertical Applications.

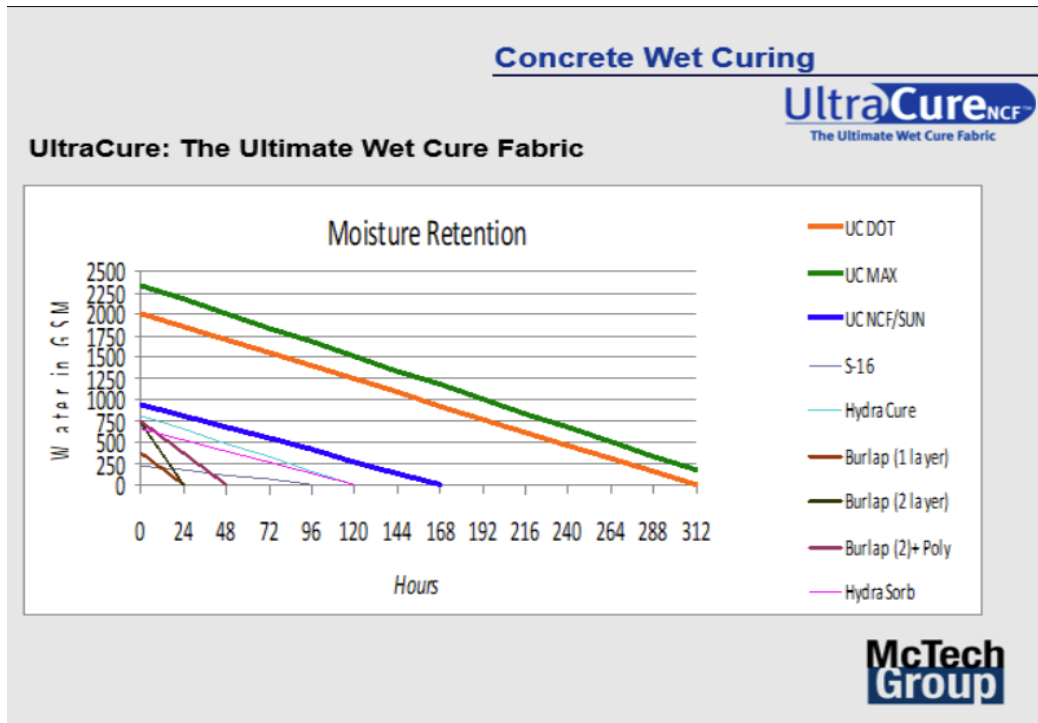

### Why UltraCure DOT™ for Vertical Applications.

- Stronger cured concrete at a more economical overall cost
- Increased cured concrete strength
- Improved concrete freeze/thaw resistance
- Less voids = water tightness
- Higher volume stability
- Greater blanket wind resistance
- Reduced water consumption for curing
- Near elimination of water runoff into environment
- Greener – LEED's points & recyclable
- Reduced labor costs to maintain surface wetness

**Lightweight:** each roll weights approx. 50 lbs.

**Rolls out more evenly & flatter than traditional methods.**

**Less Material Overlap:** 4-6".

**Superior Absorption:** each roll holds up to 55 gallons of water.

**Wrinkles & air bubbles squeegee out**

**Concrete remains moist up to 14 days.**

## Vertical Installation Instructions

### Vertical Applications:

#### 1 Sided Wall

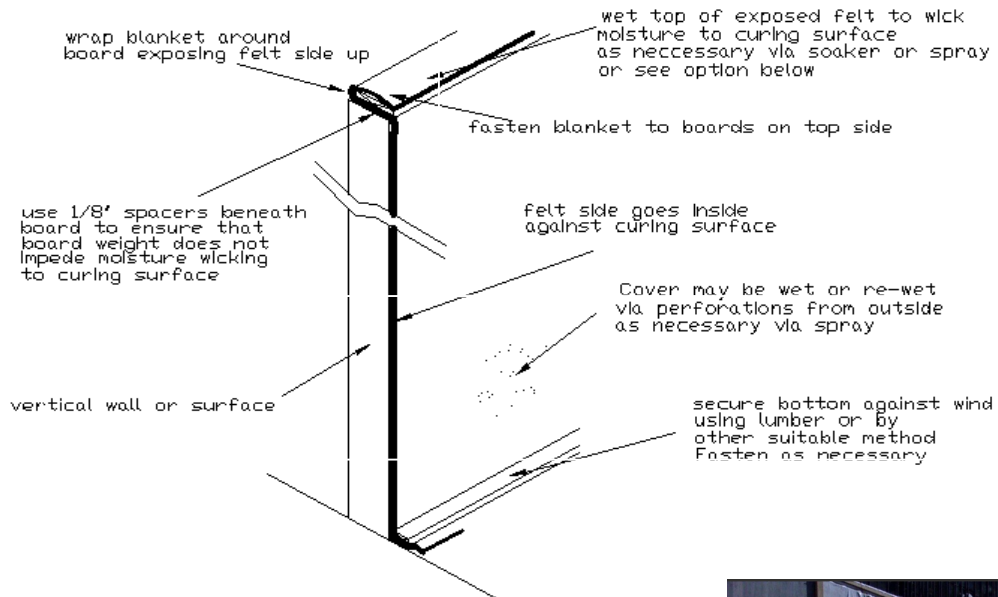

# UltraCure DOT™

## Vertical Installation Instructions

### Vertical Applications:

#### 2 Sided Wall

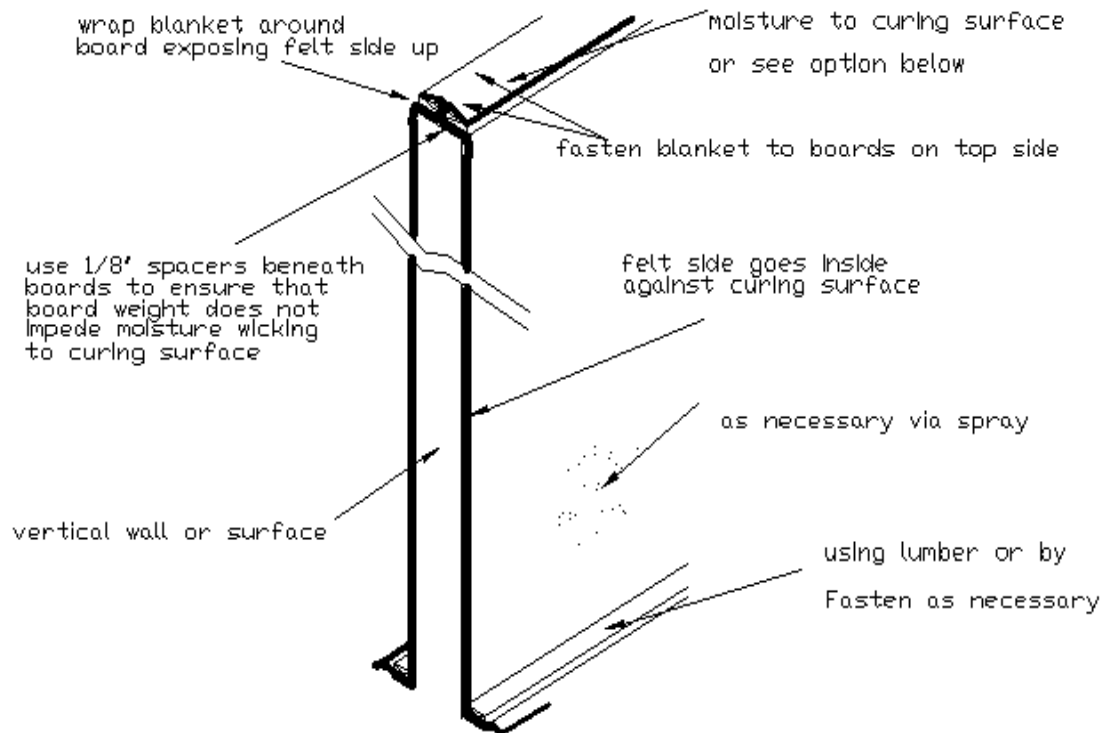

# UltraCure DOT™

## Vertical Installation Instructions

### Vertical Applications:

#### Jersey Wall

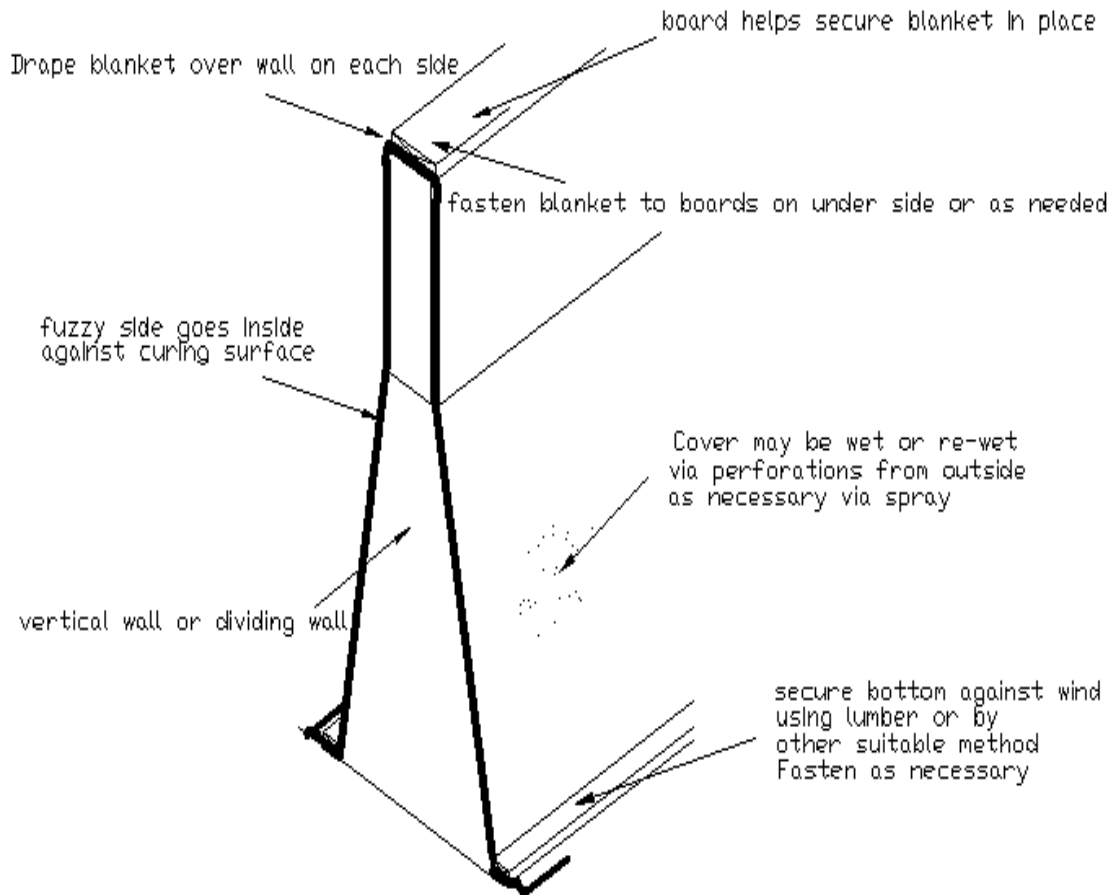

For support call: 1-866-913-8363  
[www.McTechGroup.com](http://www.McTechGroup.com)

Refer to McTech Group safety policy which is available  
[www.McTechGroup.com](http://www.McTechGroup.com).